

Our Services

Planning & Design
Manufacturing
Installation

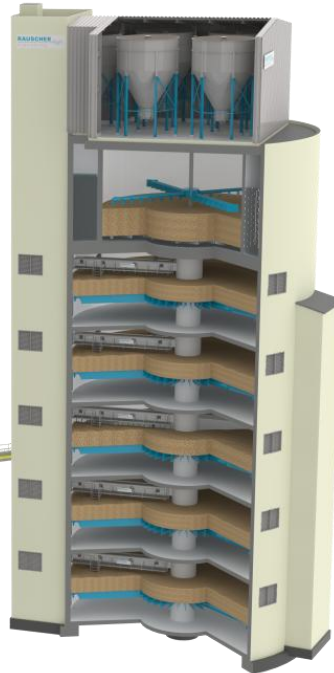
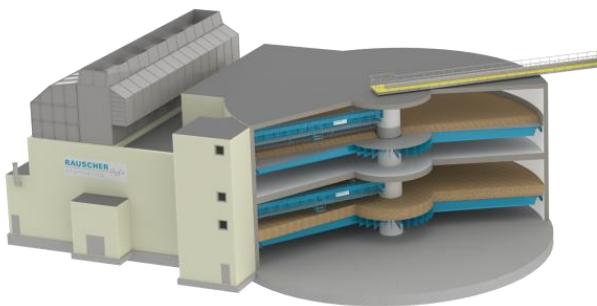

- Steeping plants
- Germination plants
- Kilning plants
- Germination/kilning plants
- Special malting equipment
- Plant optimizing

- Projecting and decision-making
- Planning & Detail design
- Air-flow analysis
- Manufacturing
- Installation
- Commissioning
- Maintenance repairs
- Spare parts

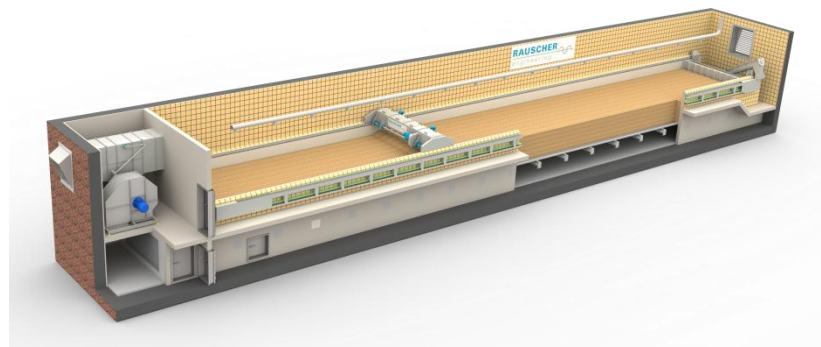
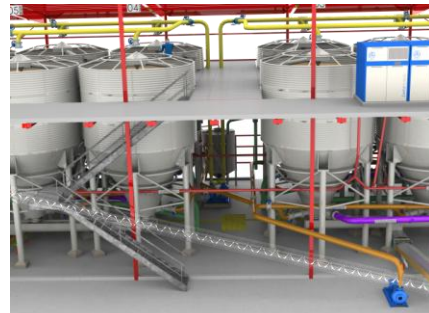

North and South America

Mr. Reiner Weigel

Phone: +1 204 - 355 - 85 65

E-Mail: weigel@rauscher-engineering.net

Rauscher Engineering GmbH & Co. KG

Beerbacher Str. 10
91463 Dietersheim/Germany,

 +49 (0) 91 61 / 66 21 - 38

 +49 (0) 91 61 / 66 21 - 29

 info@rauscher-engineering.net

 www.rauscher-engineering.net

Projecting and decision-making

Not only do we project your new malting plants but we also undertake extension, reconstruction and modernization of existing malting equipment. It is part and parcel of our work that we study your ideas and specifications as well as the local conditions and state-of-the-art technology. Our project proposal includes energy consumption calculations and we advise you as to the selection of the different options in plant design. We also prepare initial budget calculations to estimate your total investment.

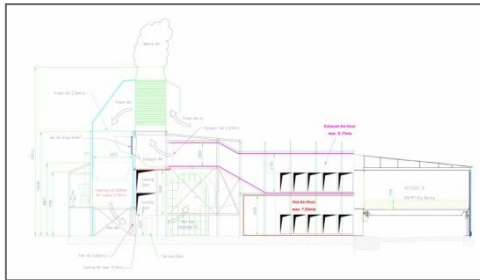

Planning

We generate the complete planning documentation including site plans and layout drawings for the individual components as well as supplying all the necessary approval drawings and documentation for governmental and local authorities. We also provide you with the necessary technical specifications and work out tenders for potential suppliers of individual components.

Air-flow analysis

Years of experience and a tailor-made 3-D program enable us to simulate and analyze the air flow; this means that we can ensure optimum air flow with a low loss level.

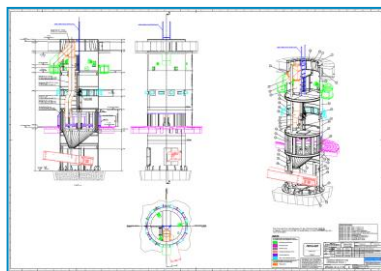
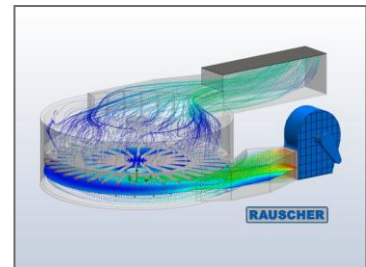

Detailed design

We generate detailed plans complying with commercial norms (workshop drawings) for manufacture at a company qualified for this purpose. Our manufacturing plans include all the relevant technical details. We provide the parts lists for purchase, manufacturing and assembly as well as providing any assembly drawings required as well as drawings for services provided locally.

Manufacturing

Rauscher Engineering works with selected qualified manufacturing companies which we monitor regularly and support throughout the project.



Installation

Expert installation of the plant and its components is effected by highly qualified and experienced technicians selected by Rauscher Engineering.

Commissioning

Commissioning is effected by experienced technicians who document the process.

North and South America

Mr. Reiner Weigel

Phone: +1 204 - 355 - 85 65

E-Mail: weigel@rauscher-engineering.net

Rauscher Engineering GmbH & Co. KG

Beerbacher Str. 10
91463 Dietersheim/Germany,

☎ +49 (0) 91 61 / 66 21 - 38

☎ +49 (0) 91 61 / 66 21 - 29

✉ info@rauscher-engineering.net

🌐 www.rauscher-engineering.net